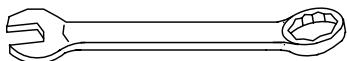




<b>Italiano</b>	ISTRUZIONI DI MONTAGGIO
<b>English</b>	ASSEMBLY INSTRUCTIONS
<b>Deutsch</b>	MONTAGEANLEITUNG
<b>Français</b>	INSTRUCTIONS DE MONTAGE
<b>Español</b>	INSTRUCCIONES PARA EL ENSAMBLAJE
<b>Português</b>	INSTRUÇÕES DE MONTAGEM
<b>Nederlands</b>	MONTAGE HANDLEIDING
<b>Polski</b>	INSTRUKCJA MONTAŻOWA
<b>Česky</b>	NÁVOD NA MONTÁŽ
<b>Magyar</b>	ÖSSZESZERELÉSI ÚTMUTATÓ
<b>Română</b>	INSTRUCȚIUNI DE MONTAJ
<b>Русский</b>	Инструкции по установке
<b>Hrvatski</b>	UPUTE ZA MONTAŽU
<b>Srpski</b>	UPUTE ZA MONTAŽU
<b>Slovenščina</b>	NAVODILO ZA MONTAŽO
<b>Dansk</b>	MONTERINGSINSTRUKTIONER
<b>Svenska</b>	MONTERINGSINSTRUKTIONER
<b>Suomi</b>	ASENNUSOHJEET
<b>Eesti keel</b>	MONTAAŽIJUHEND





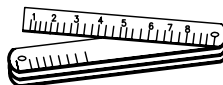
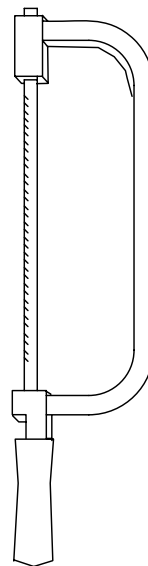
10 - 13 - 19 mm

$\frac{25}{64}$ " -  $\frac{33}{64}$ " -  $\frac{3}{4}$ " in



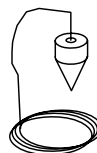
3 - 5 - 6 - 10 mm

$\frac{1}{8}$ " -  $\frac{13}{64}$ " -  $\frac{15}{64}$ " -  $\frac{25}{64}$ " in



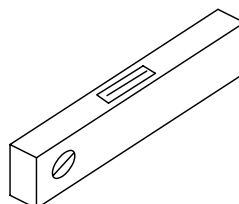
Ø 8x120 - Ø 14x150 mm

Ø  $\frac{5}{16}$ " x  $4\frac{3}{4}$ " - Ø  $\frac{9}{16}$ " x  $5\frac{7}{8}$ " in



Ø 6.5 mm

Ø  $\frac{1}{4}$ " in



## English

Before starting the assembly process, unpack all components of the staircase. Lay them out on a large surface and check the quantity of all the pieces, by consulting the table TAB.1 (A = Code, B = Quantity).

Inside the staircase box you will also find a DVD which we suggest watching before proceeding to assemble.

For customers in the USA there is a customer assistance number 1-888 STAIRKT, which you can telephone in case of problems.

### Assembly

1. Carefully measure the floor-to-floor height.
2. Calculate the rise:
  - 1) subtract 22 cm (8 ½") from the floor-to-floor height you measured,
  - 2) divide this value by the rises number minus one.Example: for the measured floor-to-floor height of 268 cm and a staircase with 12 rises:  
 $(268-22)/(12-1)=22,36$  (8'3 ½" 8 ⅝")/(12-1)=8 ¾".
3. Determine the position of the support N19 (fig. 1) keeping in mind two points:
  - 1) the rise, calculated previously, also contains the tread depth (L40) (fig. 2).
  - 2) Position the support N19 keeping in mind the opening feature (fig. 3).
4. Drill with the drill bit Ø 14 mm.
5. Assemble on the floor, in a straight line, the supports N19, N18, N17 and N16 keeping in mind the calculated rise. Use the parts C15, B71 and B75 (fig. 1). Tighten sufficiently keeping in mind that the supports N19, N18, N17 and N16 still have to rotate for the configurations B, C, D.
6. Lift and position the structure with the support N19 which has to touch the floor (fig. 4). If the stair place is too tight, it is suggested to rotate some supports.
7. Tighten the support N19 completely, by using the part C39 (fig. 1).
8. Determine at this point which is the first step from the top. Drill L40 treads using the cardboard cutout jig L41 you find in the package, alternating a right tread and a left tread (fig. 3).
9. Cut along the shape (fig. 7 - center page).
10. Decide where to assemble the railing (inside or outside) (fig. 3) and pierce the treads (L40) with the drill bit 6,5 using the template only for the straight sides. To find the fixing point on the short side of the winding treads (L40) maintain the same distance as the one between the balusters (C12) to assemble on the long side of the tread (fig. 3).
11. Assemble and tighten the parts F23 by using the parts C14, B83, C49, C13, B02 (fig. 1).
12. Attach the treads (L40) completely starting from the top to the support N16, by using the parts C40 (fig.1).
13.
  1. The configuration A (straight) doesn't need any further changes (fig. 3).
  2. The configurations B or C need a rotation of 13° (fig. 3).
  3. The configuration D needs a rotation of 18° (fig. 3).
14. To rotate the supports of 13° or 18° you have to proceed as follows:
  - a. Set out with a pencil, at the connection point of two supports, two vertical lines at a distance of 9 mm (0,35") (to rotate 13°, configuration B or C) (fig. 5) or 13 mm (0,51") (to rotate 18°, configuration D) (fig. 6).
  - b. Loosen the parts C15, one support by one, starting from the top and rotate until one of the lines matches the one of the top according to the direction of rotation.
  - c. Tighten the parts C15 completely (fig. 1).

### Assembly of the Railing

15. Assemble the parts C28 by using the parts C13, B02 and insert them into the balusters (C12) (fig. 1).
16. Insert the balusters (C12) into the parts F23, blocking them by the part B02.

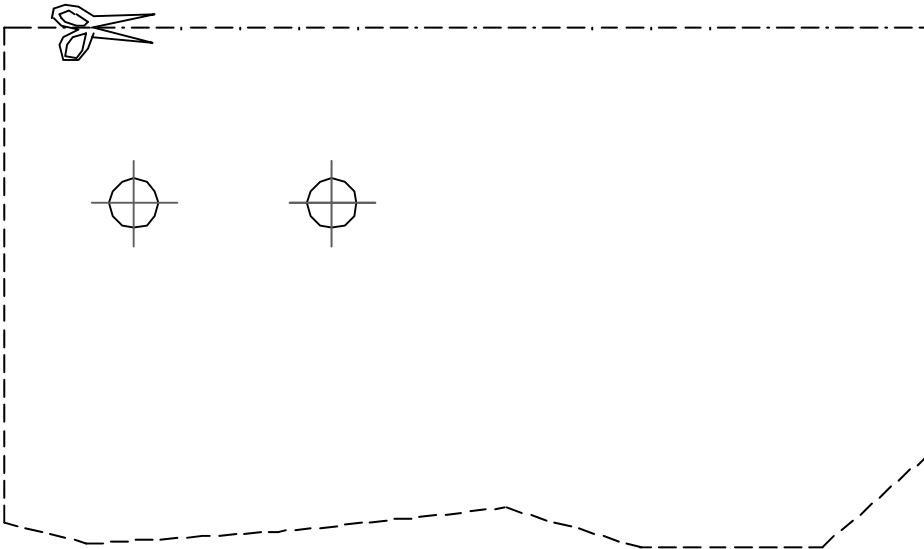
17. The first balusters (C12) of the long side of every tread (L40) have to be cut.
18. Tighten the part C28 completely, by using the part B02 (fig. 1). For a correct assembly twist the key at about 90° from the contact point.

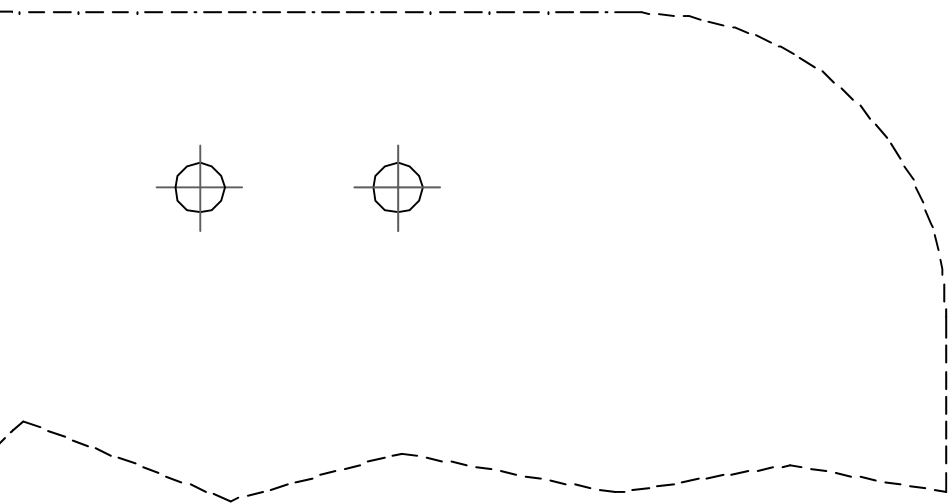
### **Final Assembly**

19. Control the vertical line of the whole stair and, if necessary, correct it by moving the support N16 (fig. 1).
20. Disassemble the first tread (L40) and drill the floor with a Ø 14 mm tip in relation to the present holes on the support N16 (fig. 1).
21. Insert the parts C39 and tighten completely (fig. 1).
22. Reassemble the first tread (L40) and fix on the floor, in relation to the first baluster (C12), the part F01, by drilling with a Ø 8 mm tip. Use the parts B11, B12, B83 and B02 (fig. 1).
23. Insert the baluster (C12) and tighten the part B02 (fig. 1).

After you have finished assembling the staircase,  
please visit our website and send us your suggestions: [www.arke.ws](http://www.arke.ws)

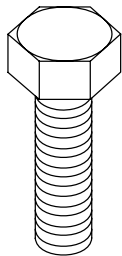
**FIG. 7**



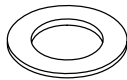


**TAB 1**

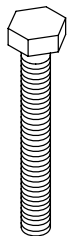
<b>A</b>	<b>B</b>
B02	62
B11	2
B12	2
B71	20
B75	40
B83	62
C12	15
C13	60
C14	30
C15	20
C28	15
C39	4
C40	44
C49	30
F01	2
F23	30
L40	11
L41	1
N16	1
N17	1
N18	8
N19	1



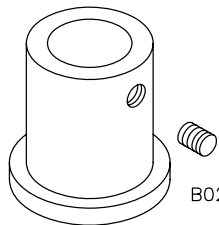
C15



B75

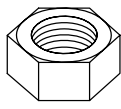


C14



F01

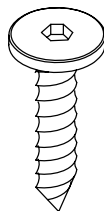
B02



B71



C49



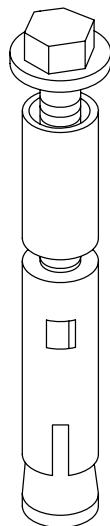
C40



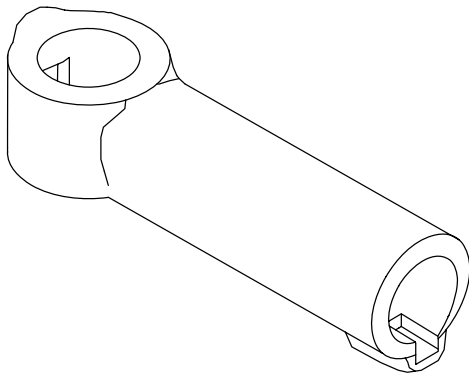
C13



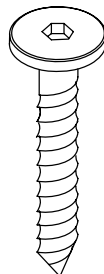
B83



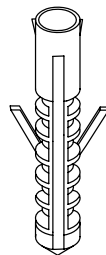
C39



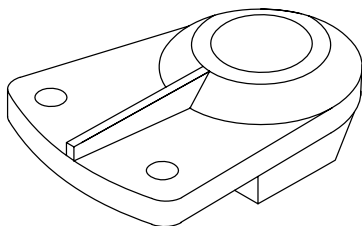
C28



B11



B12

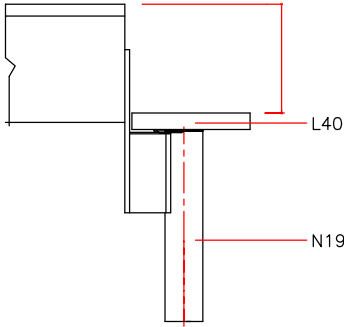


F23

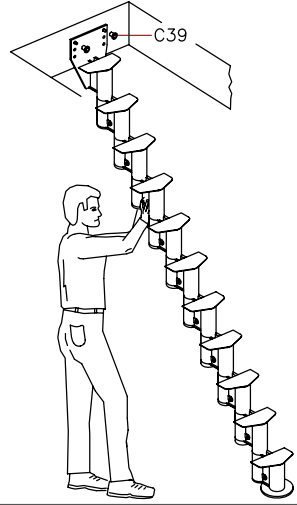




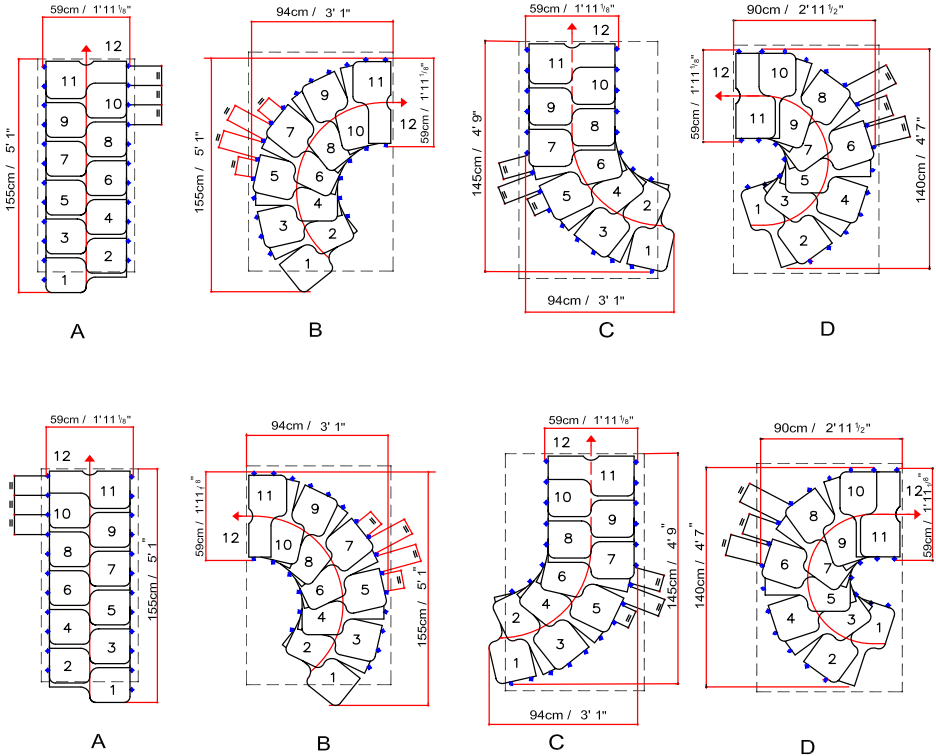
**FIG. 2**



**FIG. 4**

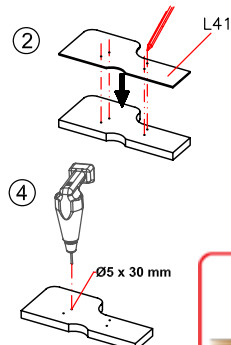
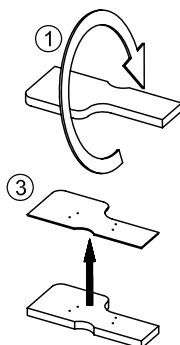
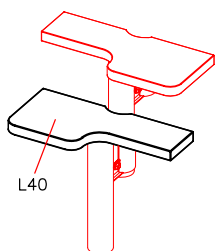
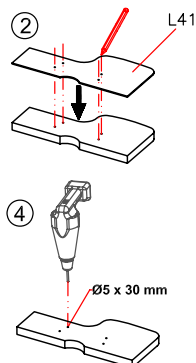
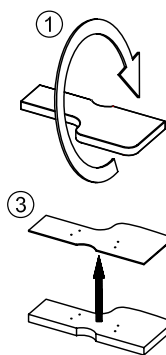
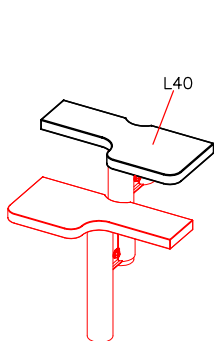


**FIG. 3**

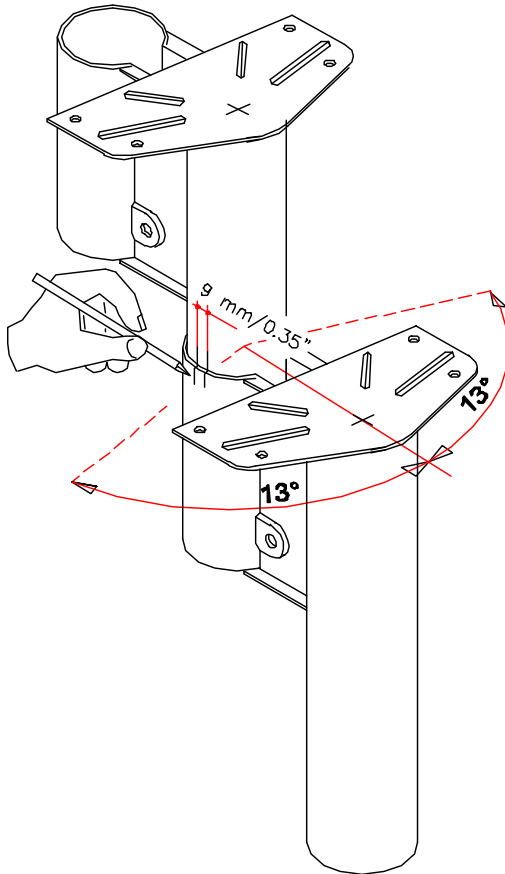


**FIG. 3**

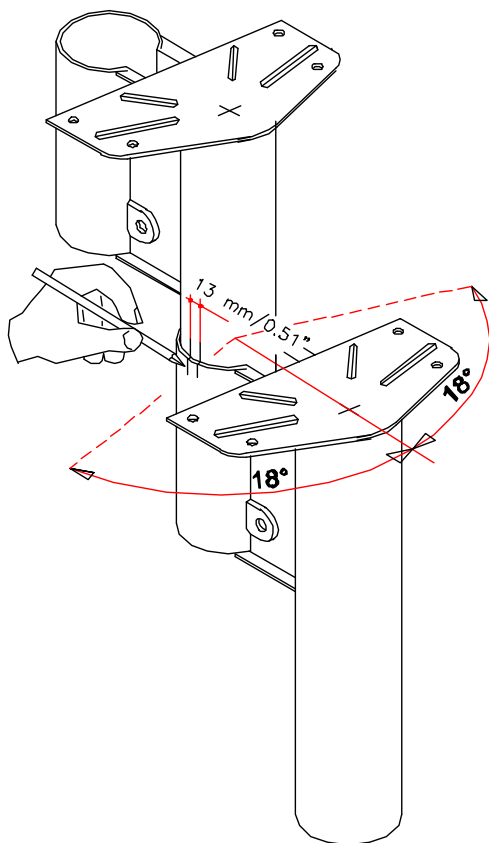
	HOHE HEIGHT ALTURA HAUTEUR ALTEZZA HOOGTE WYSOKOŚĆ ALTURA VISINA VISINA VÝŠKA HÖJDE HOUD KORKEUS <b>H cm</b>	ANZHL STUFENHÖHEN NUMBER OF RISERS NÚMERO TABLIAS NOMBRE HAUTEURS NUMERO ALZATE AANTAL OPTREDENS ILOŚĆ WYSOKOŚCI NÚMERO DE ALTURAS BROJ GAZISTA ŠTEVILO VIŠIN POČET VÝŠEK SCHODŮ ANTAL STIGNINGER NUMMER STEG NOUSUNJEN MÄÄRÄ	ANZHL STUFEN NUMBER OF TREADS NÚMERO Peldaños NOMBRE MARCHES NUMERO GRADINI AANTAL TREDEN ILOŚĆ STOPNI NÚMERO DE DEGRAUS BROJ GAZISTA ŠTEVILO STOPNIC POČET SCHODNIC ANTAL TRIN NUMMER TRAPPSTEG ASKELMEN MÄÄRÄ	STUFENHOHE MEASURE OF RISERS TABLIAS VALEUR DES HAUTEURS VALORE ALZATA HOOGTE OPTREDEN WYSOKOŚĆ VALOR ALTURA VISINA GAZISTA VISINA STOPNE PLOŠČE HODNOTA VÝŠKY SCHODŮ STIGNINGSVÆDNER STEG NOUSUN KORKEUS <b>cm</b>	ERSTE STUFE OBEN 1st TREAD ON TOP PRIMERO Peldaño EN ALTO 1ère MARCHÉ EN HAUT GRADINO DI PARTENZA DALL'ALTO ERSTE TREAD BOVEN PIERWSZY STOPIEN OD GÓRI 1° DEGRAU EM CIMA GORNJE POLAZNO GAZISTE ZGORNJA STOPNA PLOŠČA POČATEČNÍ SCHODNICE NAHOŘE STARTTRIN FRA OVEN FÖRSTA TRAPPSTEGET UPPIFRÅN ALKUASKELMA YLHÄÄLTÄ LÄHTIEN	ERTSE STUFE UNTEN 1st TREAD ON BOTTOM PRIMERO Peldaño ABAJO 1ère MARCHÉ EN BAS GRADINO DI PARTENZA DAL BASSO ERSTE TREAD VAN BENEDE PIERWSZY STOPIEN OD DOLU 1° DEGRAU EM BAIXO DOLJE POLAZNO GAZISTE SPODNIA STOPNA PLOŠČA POČATEČNÍ SCHODNICE DOLE STARTTRIN FRA NEDEN FÖRSTA TRAPPSTEGET NERIFRÅN ALKUASKELMA ALHÄÄLTÄ LÄHTIEN
KIT	209+258.5	11	10	19 + 23.5		
	228+282	12	11	19 + 23.5		
	247+305.5	13	12	19 + 23.5		
	266+329	14	13	19 + 23.5		



**FIG. 5**



**FIG. 6**



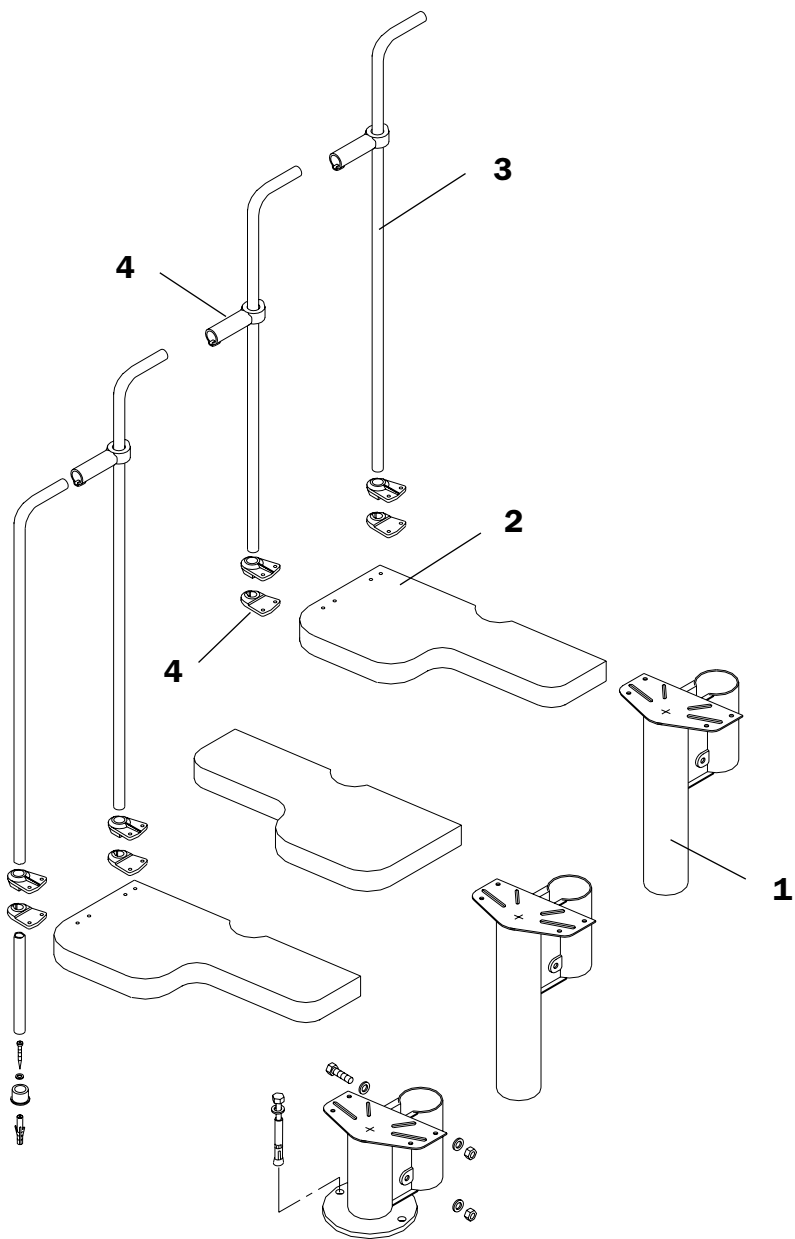




---

<b>Italiano</b>	DATI IDENTIFICATIVI DEL PRODOTTO
<b>English</b>	PRODUCT DETAILS
<b>Deutsch</b>	PRODUKTEIGENSCHAFTEN
<b>Français</b>	DONNÉES D'IDENTIFICATION DU PRODUIT
<b>Español</b>	DATOS DE IDENTIFICACIÓN
<b>Português</b>	DADOS DE IDENTIFICAÇÃO
<b>Nederlands</b>	KENMERKENDE PRODUCTGEGEVENS
<b>Polski</b>	DANE IDENTYFIKACYJNE PRODUKTU
<b>Česky</b>	IDENTIFIKAČNÍ ÚDAJE O VÝROBKU
<b>Magyar</b>	A TERMÉK AZONOSÍTÓ ADATAI
<b>Română</b>	DATELE DE IDENTIFICARE A PRODUSULUI
<b>Русский</b>	ИДЕНТИФИКАЦИОННЫЕ ДАННЫЕ ТОВАРА
<b>Hrvatski</b>	IDENTIFIKACIJSKI LIST PROIZVODA
<b>Srpski</b>	IDENTIFIKACIONSI LIST PROIZVODA
<b>Slovenščina</b>	IDENTIFIKACIJSKI LIST IZDELKA
<b>Dansk</b>	PRODUKTETS IDENTIFIKATIONSDATA
<b>Svenska</b>	PRODUKT DETALJER
<b>Suomi</b>	TIETOJA TUOTTEESTA
<b>Eesti keel</b>	TOOTE ANDMED

---





## I)

### **dati identificativi del prodotto**

denominazione commerciale: **KR**

tipologia: scala a giorno con gradini sfalsati e rotazione delle rampe con pendenza

### **materiali impiegati**

#### **STRUTTURA**

##### **descrizione**

composta da elementi **(1)** metallici assemblati fra di loro con bulloni

##### **materiali**

Fe 370

##### **finitura**

verniciatura a forno con polveri epossidiche

#### **GRADINI**

##### **descrizione**

gradini **(2)** legno sagomati assemblati alla struttura con bulloni

##### **materiali**

faggio

##### **finitura**

tinta all'acqua

fondo poliuretano

finitura poliuretano

#### **RINGHIERA**

##### **descrizione**

composta da colonnine **(3)** verticali in metallo fissate ai gradini **(2)**

##### **materiali**

colonnine: Fe 370

fissaggi **(4)**: nylon

##### **finitura**

colonnine: verniciatura a forno con polveri epossidiche

#### **PULIZIA**

pulire con panno morbido inumidito in acqua, privo di qualsiasi prodotto contenente solventi o materiali abrasivi.

#### **MANUTENZIONE**

dopo circa 12 mesi dalla data di installazione, controllare il serraggio della viteria dei vari componenti. la manutenzione straordinaria deve essere eseguita a regola d'arte.

#### **PRECAUZIONI D'USO**

evitare usi impropri e non consoni al prodotto. eventuali manomissioni o installazioni non rispondenti alle istruzioni del produttore possono inficiare le conformità prestabilite del prodotto.

## GB)

### **product details**

trade name: **KR**

type: flight staircase with alternate treads and flight rotation with slope

### **used materials**

#### **STRUCTURE**

##### **description**

composed by metallic elements **(1)** assembled between themselves by bolts

##### **materials**

Fe 370

##### **finishing**

oven varnishing with epoxy powders

#### **TREADS**

##### **description**

treads **(2)** shaped in wood assembled to the structure by bolts

##### **materials**

beech

##### **finishing**

water-base colour

polyurethane undercoat

polyurethane finishing

#### **RAILING**

##### **description**

composed by vertical balusters **(3)** in metal fixed to the treads **(2)**

##### **materials**

balusters: Fe 370

fixings **(4)**: nylon

##### **finishing**

spindles: oven varnishing with epoxy powders

#### **CLEANING**

clean with a soft wet cloth, without any product containing solvents or abrasive materials.

#### **MAINTENANCE**

about 12 months after the installation date, check the tightening of bolts on the various components. all non-routine maintenance procedures must be carried out in a strictly professional manner.

#### **USE PRECAUTION**

avoid any improper use that is not in accordance with the product. possible violations or installations which don't comply with the providers instructions can invalidate the agreed product conformities.



**KR**  
**2012**

D.U.M  
09/2012



—  
arkè by Fontanot  
Albini & Fontanot S.p.A.  
Via P. Paolo Pasolini, 6  
47853 Cerasolo Ausa  
Rimini, Italy

tel. +39.0541.90.61.11  
fax +39.0541.90.61.24  
info@arke.ws  
www.arke.ws

cod. 066529000